

Trees to be Removed Appraisal Values:

No.	Common Name	Species	DBH/Ht./Qty	Cond.	Price per in / ft	Value Before Diminution	Value
1	Green Buttonwood	<i>Conocarpus erectus</i>	20	50%	\$ 163.00	\$ 3,260.00	\$ 1,630.00
2	Pigeon Plum	<i>Coccoloba diversifolia</i>	3.5	70%	\$ 107.00	\$ 374.50	\$ 262.15
12	Lysiloma Sabicu	<i>Lysiloma Sabicu</i>	8	50%	\$ 297.00	\$ 2,376.00	\$ 1,188.00
13	Lysiloma Sabicu	<i>Lysiloma Sabicu</i>	8	50%	\$ 297.00	\$ 2,376.00	\$ 1,188.00
15	Green Buttonwood	<i>Conocarpus erectus</i>	20	50%	\$ 163.00	\$ 3,260.00	\$ 1,630.00
16	Green Buttonwood	<i>Conocarpus erectus</i>	20	50%	\$ 163.00	\$ 3,260.00	\$ 1,630.00
17	Pink Tabebuia	<i>Tabebuia heterophylla</i>	3	80%	\$ 166.66	\$ 499.98	\$ 399.98
18	Green Buttonwood	<i>Conocarpus erectus</i>	20	50%	\$ 163.00	\$ 3,260.00	\$ 1,630.00
19	Green Buttonwood	<i>Conocarpus erectus</i>	20	50%	\$ 163.00	\$ 3,260.00	\$ 1,630.00
20	Lysiloma Sabicu	<i>Lysiloma Sabicu</i>	8	50%	\$ 297.00	\$ 2,376.00	\$ 1,188.00
21	Lysiloma Sabicu	<i>Lysiloma Sabicu</i>	8	50%	\$ 297.00	\$ 2,376.00	\$ 1,188.00
22	Green Buttonwood	<i>Conocarpus erectus</i>	20	50%	\$ 163.00	\$ 3,260.00	\$ 1,630.00
23	Lysiloma Sabicu	<i>Lysiloma Sabicu</i>	8	50%	\$ 297.00	\$ 2,376.00	\$ 1,188.00
36	Lysiloma Sabicu	<i>Lysiloma Sabicu</i>	8	50%	\$ 297.00	\$ 2,376.00	\$ 1,188.00
37	Green Buttonwood	<i>Conocarpus erectus</i>	20	50%	\$ 163.00	\$ 3,260.00	\$ 1,630.00
38	Green Buttonwood	<i>Conocarpus erectus</i>	20	50%	\$ 163.00	\$ 3,260.00	\$ 1,630.00
39	Lysiloma Sabicu	<i>Lysiloma Sabicu</i>	8	50%	\$ 297.00	\$ 2,376.00	\$ 1,188.00
40	Lysiloma Sabicu	<i>Lysiloma Sabicu</i>	8	50%	\$ 297.00	\$ 2,376.00	\$ 1,188.00
41	Lysiloma Sabicu	<i>Lysiloma Sabicu</i>	8	50%	\$ 297.00	\$ 2,376.00	\$ 1,188.00
81	Royal Palm	<i>Roystonea elata</i>	18	50%	\$ 129.16	\$ 2,324.88	\$ 1,162.44
90	Pigeon Plum	<i>Coccoloba diversifolia</i>	3.5	50%	\$ 107.00	\$ 374.50	\$ 187.25
91	Royal Palm	<i>Roystonea elata</i>	14	50%	\$ 129.16	\$ 1,808.24	\$ 904.12
134	Green Buttonwood	<i>Conocarpus erectus</i>	20	50%	\$ 163.00	\$ 3,260.00	\$ 1,630.00
143	Triple Christmas Palm	<i>Adonidia merrillii</i>	14	50%	\$ 28.64	\$ 400.96	\$ 200.48
144	Double Christmas Palm	<i>Adonidia merrillii</i>	14	50%	\$ 28.64	\$ 400.96	\$ 200.48
148	Double Alexander Palm	<i>Ptychosperma elegans</i>	15	50%	\$ 30.00	\$ 450.00	\$ 225.00
149	Double Alexander Palm	<i>Ptychosperma elegans</i>	18	50%	\$ 30.00	\$ 540.00	\$ 270.00
150	Double Alexander Palm	<i>Ptychosperma elegans</i>	20	50%	\$ 30.00	\$ 600.00	\$ 300.00
151	Sabal Palm	<i>Sabal palmetto</i>	1	50%	\$ 233.33	\$ 233.33	\$ 116.67
152	Sabal Palm	<i>Sabal palmetto</i>	1	50%	\$ 233.33	\$ 233.33	\$ 116.67
153	Sabal Palm	<i>Sabal palmetto</i>	1	50%	\$ 233.33	\$ 233.33	\$ 116.67
154	Sabal Palm	<i>Sabal palmetto</i>	1	50%	\$ 233.33	\$ 233.33	\$ 116.67
155	Sabal Palm	<i>Sabal palmetto</i>	1	50%	\$ 233.33	\$ 233.33	\$ 116.67
156	Sabal Palm	<i>Sabal palmetto</i>	1	50%	\$ 233.33	\$ 233.33	\$ 116.67

Total Value \$ 30,173.89

-In lieu of replacement on site due to a lack of planting space, funds will be deposited into the Tree Canopy Trust Fund as detailed in Section 36.033. Values above were provided by Sutton Consulting Arborist, Inc.

-A Total of \$30,173.89 will be paid to the Tree Canopy Trust Fund for Mitigation.

Notes - Tree and Palm Protection

- Fences shall be erected to protect trees and palms to be preserved. Fences define a specific protection zone for each tree or group of trees. Fences shall be installed prior to the beginning of construction and are to remain until all site work has been completed. Fences may not be relocated or removed without the written permission of the Arborist. Refer to the Landscape Architect's Tree Protection Detail.
- Construction trailers, traffic, and storage areas must remain outside fenced areas at all times.
- All underground utilities lines shall be routed outside the tree protection zone. If lines must traverse the protection area, disturbance shall be minimized by using techniques such as tunneling or boring.
- No materials, equipment, spoil, or waste or washout water may be deposited, stored, or parked within the tree protection zone.
- Additional tree pruning required for clearance during construction must be approved by the Certified Arborist and shall be performed by trained arborists, not by construction personnel.
- If injury should occur to any tree during construction, it should be evaluated as soon as possible by the Landscape Contractor and the Certified Arborist should be notified immediately.
- Any grading, construction, demolition, or other work that is expected to encounter tree roots must be monitored by the Landscape Contractor.
- All trees shall be irrigated at least two times a week. Each irrigation session shall wet the soil within the tree protection zone to a depth of 30 inches.
- Before grading, pad preparation, or excavation for foundations, footings, walls, or trenching near trees the trees shall be root pruned at the edge of the tree protection zone by cutting all roots cleanly to a depth of 36 inches. Roots shall be cut manually by digging a trench and cutting exposed roots with a saw, vibrating knife, rock saw, narrow trencher with sharp blades, or other approved root-pruning equipment.
- Any roots damaged during grading or construction shall be exposed to sound tissue and cut cleanly with a saw.
- Spill from trenches, basements, or other excavations shall not be placed within the tree protection zone, either temporarily or permanently.
- No burn piles or debris pits shall be placed within the tree protection zone. No ashes, debris, or garbage may be dumped or buried within the tree protection zone.
- Maintain fire-safe areas around the fences. Also, no heat sources, flames, ignition sources, or smoking is allowed near mulch or trees.
- Protective barriers shall be placed around each tree, cluster of trees, or the edge of the preservation area at the specified distance. Protective barriers shall be a minimum of four feet above ground level and shall be constructed of wood, plastic, or metal, and shall remain in place until development is completed. Protective barriers shall be in place prior to the start of any construction.
- Understory plants within protective barriers shall be protected.
- No excess oil, fill, equipment, building materials or building debris shall be placed within the areas surrounded by protective barriers, nor shall there be disposal of any waste material such as paints, oils, solvents, asphalt, concrete, mortar or any other material harmful to trees or understory plants within the areas surrounded by protective barriers.
- Trees shall not be braced in such a fashion as to scar, penetrate, perforate or otherwise inflict damage to the tree.
- Natural grade shall be maintained within protective barriers. In the event that the natural grade of the site is changed as a result of site development such that the safety of the tree may be endangered, tree wells or retaining walls are required.
- Fences and walls shall be constructed to avoid disturbance to any protected tree. Post holes and trenches located close to trees shall be dug by hand and adjusted as necessary, using techniques such as discontinuous footings, to avoid damage to major roots.

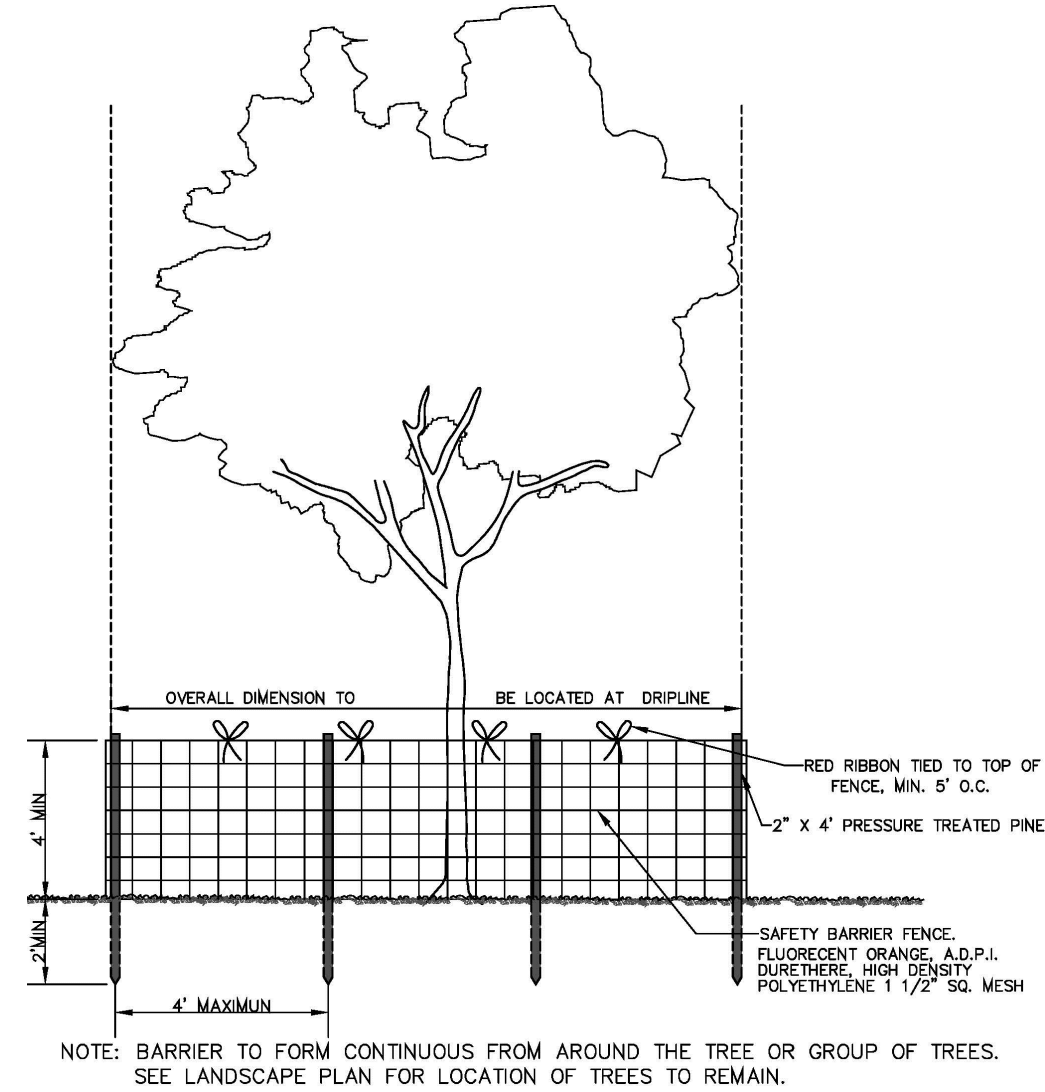

TREE BARRICADE DETAIL

*TREE BARRICADES ONLY REQUIRED WITHIN LIMITS OF RESTAURANT CONSTRUCTION

Note: Trees inherently pose a certain degree of hazard and risk from breakage, failure or other causes and conditions. Recommendations that are made are intended to minimize or reduce such hazardous conditions. However, there can be no guarantee or warranty that efforts to discover or correct unsafe conditions will prevent future breakage or failure, nor can there be any guarantee that all hazardous conditions have been detected. The client should not rely that a tree is safe either because services have been recommended or done to reduce risk, or because no services have been recommended or done on a specific tree. The client assumes any and all risks associated with pursuing consultant's advice and fully understands that he or she is engaged in securing professional consultation regarding the above-mentioned property.

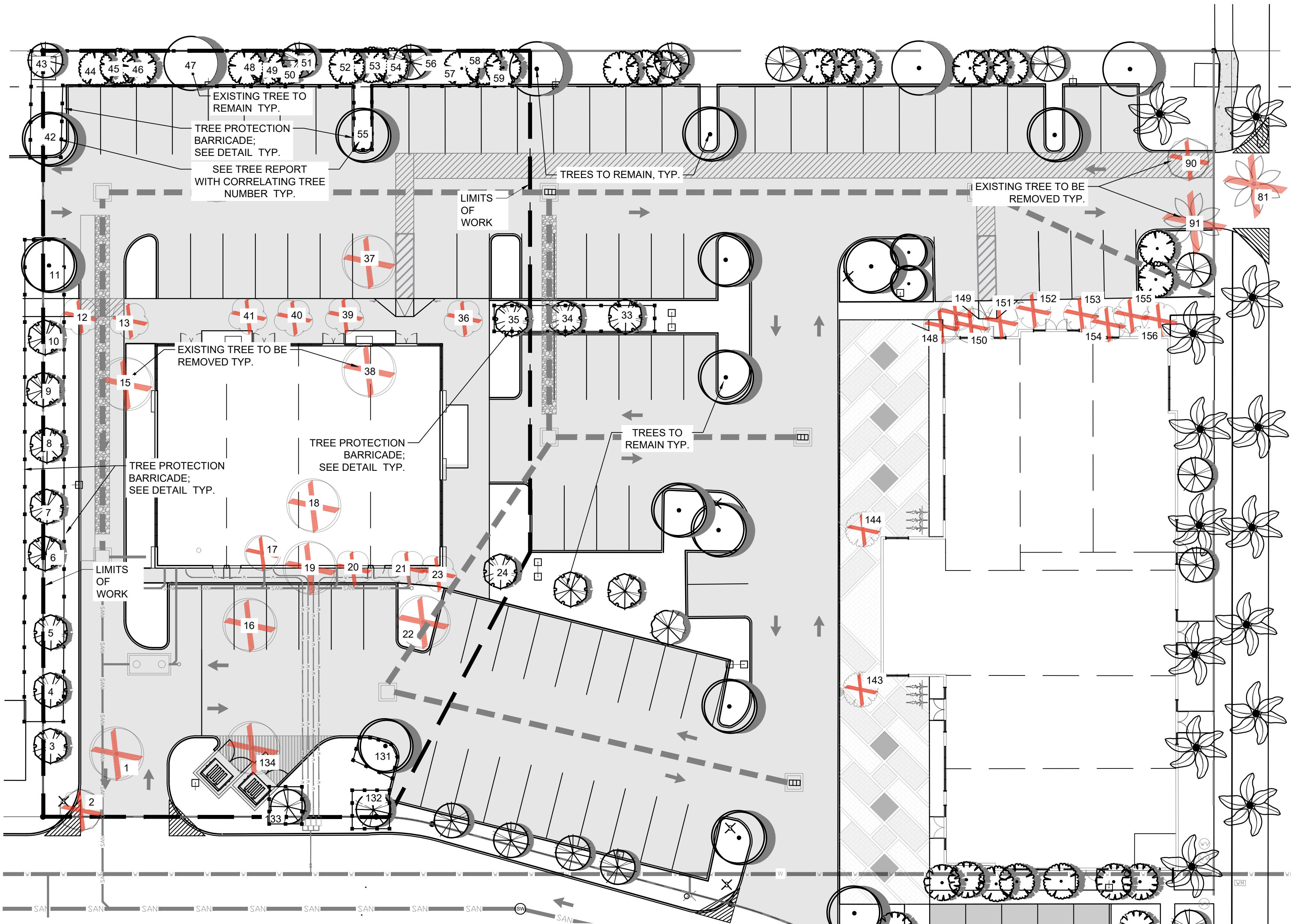

PLANT SCHEDULE TREE DISPOSITION

SYMBOL	CODE	QTY	BOTANICAL NAME	COMMON NAME	CONTAINER	HEIGHT	WIDTH	NOTES	NATIVE	CALIPER
EXISTING TREES TO BE REMOVED										
	ADR	2	Adonidia merrillii	Christmas Palm Double	Existing To Be Removed	14' CT		SEE TREE REPORT FOR DETAILS	Non-native	Varies
	CCD	2	Coccoloba diversifolia	Pigeon Plum	Existing To Be Removed	VARIES 16'-24' OA		SEE TREE REPORT FOR DETAILS	Native	Varies, 6"-10"
	C-RR	9	Conocarpus erectus	Buttonwood	Existing To Be Removed	VARIES 16'-24' OA	VARIES 10' - 20' W	SEE TREE REPORT FOR DETAILS	Native	VARIES 12"-20" DBH
	LSR	9	Lysiloma	Wild Tamarind	Existing To Be Removed	14'-16' HT	VARIES 8'-12' W	SEE TREE REPORT FOR DETAILS	Non-native	VARIES 4"-11"
	PER	3	Ptychosperma elegans	Alexander Palm	Existing To Be Removed					
	R-RR	2	Roystonea elata	Florida Royal Palm	Existing To Be Removed	16' GW		SEE TREE REPORT FOR DETAILS	Native	
	SSR	6	Sabal palmetto	Cabbage Palmetto	Existing To Be Removed	VARIES 16'-24' OA		SEE TREE REPORT FOR DETAILS	Native	
	TBR	1	Tabebuia heterophylla	Pink Tabebuia	Existing To Be Removed	14'-16' HT	VARIES 6'-12' W	SEE TREE REPORT FOR DETAILS	Non-native	VARIES 4"-11"
EXISTING TREES TO REMAIN										
	CDP	17	Coccoloba diversifolia	Pigeon Plum	Existing to Remain	14'-16' HT	VARIES 8'-12' W	SEE TREE REPORT FOR DETAILS	Native	VARIES 4"-11"
	CE-R	14	Conocarpus erectus	Buttonwood	Existing to Remain	VARIES 16'-24' OA	VARIES 10' - 20' W	SEE TREE REPORT FOR DETAILS	Native	VARIES 12"-20" DBH
	LSB	14	Lysiloma Sabicu	Sabicu	Existing to Remain	14'-16' HT	VARIES 8'-12' W	SEE TREE REPORT FOR DETAILS	Non-native	VARIES 4"-11"
	PEX	2	Ptychosperma elegans	Alexander Palm	Existing to Remain					
	QV-R	4	Quercus virginiana	Southern Live Oak	Existing to Remain	VARIES 16'-24' OA	VARIES 10' - 20' W	SEE TREE REPORT FOR DETAILS	Native	VARIES 12"-20" DBH
	RE-R	18	Roystonea elata	Florida Royal Palm	Existing to Remain	16' GW		SEE TREE REPORT FOR DETAILS	Native	
	SP-R	35	Sabal palmetto	Cabbage Palmetto	Existing to Remain	14'-22' OA, MIX HTS		SEE TREE REPORT FOR DETAILS	Native	
	THH	1	Tabebuia heterophylla	Pink Tabebuia	Existing to Remain	14'-16' HT	VARIES 8'-12' W	SEE TREE REPORT FOR DETAILS	Native	VARIES 4"-11"
	VS-R	8	Veitchia spp	Veitchia Species	Existing to Remain	VARIES 16'-24' OA		SEE TREE REPORT FOR DETAILS	Non-native	

Project Team

Landscape Architect:

LANDSCAPE ARCHITECTURAL SERVICES, LLC

Brandon White | Owner
772-834-1357 | brandon@las-fl.com
Paul Goulas | Owner
772-631-8400 | paul@las-fl.com
1708 SE Joy Haven Street
Port St. Lucie, FL 34983

Architect:

DesignTech International

Architects • Planners • Interior Design
14101 N.W. 88th Ave., Suite 303
Miami Lakes, FL 33018
P: 305-562-4420
www.designtechintl.com

FOLIO 4942-03-27-0012
PROPOSED SHELL BLDG

2100 W ATLANTIC BLVD
POMPANO BEACH, FLORIDA 33069

Tree Disposition Plan

Revisions		
Date	Init.	Description
07.26.22	PG	Initial Submittal
12.06.22	PG	Revised per Comments
2.27.23	PG	Revised per Comments
3.29.23	PG	Revised per Comments
5.13.25	ST	Revised per Site Plan

REGISTERED LANDSCAPE ARCHITECT
PAUL A. GOULAS
LA 6666807
STATE OF FLORIDA

PAUL GOULAS, RLA
FLORIDA REG. # LA6666807

-In lieu of replacement on site due to a lack of planting space, funds will be deposited into the Tree Canopy Trust Fund as detailed in Section 36.033.

-See Tree Report by Sutton Consulting Arborist Inc. for existing tree information & values.

Drawn By: PG

Checked By: PG

Municipal Project:

Scale:

NORTH

SCALE: 1" = 20'

20' 40'

811 DRC

Know what's below.
Call before you dig.

12-25-12000021

07.16.2025